

## IG-42

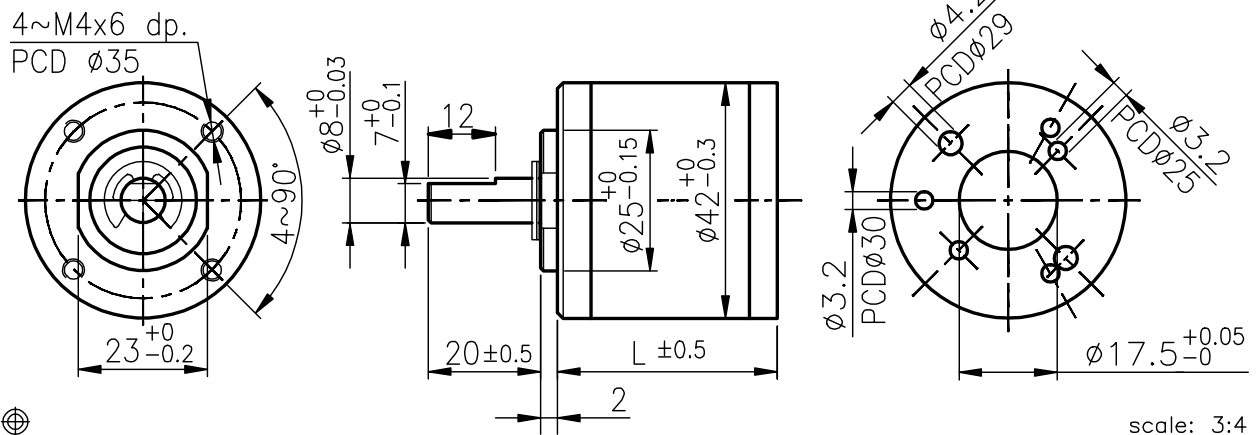

外殼材質 Housing material	金屬 metal	背隙 (無負荷時) Backlash, at no-load	$\leq 3^\circ$
輸出軸承型式 Bearing at output	含油軸承 Sleeve bearings	滾珠軸承 Ball bearings	
徑向負荷 Radial load (10mm from flange)	$\leq 5 \text{ kgf}$	$\leq 8 \text{ kgf}$	
軸向負荷 Shaft axial load	$\leq 3 \text{ kgf}$	$\leq 3 \text{ kgf}$	
主軸最大承受壓入力 Shaft press fit force, max.	$\leq 15 \text{ kgf}$	$\leq 15 \text{ kgf}$	
徑向間隙 Radial play of shaft	$\leq 0.08 \text{ mm}$	$\leq 0.05 \text{ mm}$	
軸向間隙 Thrust play of shaft	$\leq 0.3 \text{ mm}$	$\leq 0.3 \text{ mm}$	

## 外形尺寸 APPEARANCE SIZE



## 馬達齒輪型式 / PINION SPECIFICATIONS

模數 Module	0.6				
齒數 No. of teeth	12	15	18	24	20
壓力角 Pressure angle	$20^\circ$				
孔徑 Hole diameter	$\phi 3.98$	$\phi 4.98$			
減速比 Reduction ratio	1/24 1/144 1/504 1/864	1/720, 1/1062 1/1470, 1/2500 1/3000, 1/3600	1/17 1/61 1/104 1/212	1/14 1/49 1/84	1/4

## 馬達裝卸方法 / MOTOR INSTALLATION

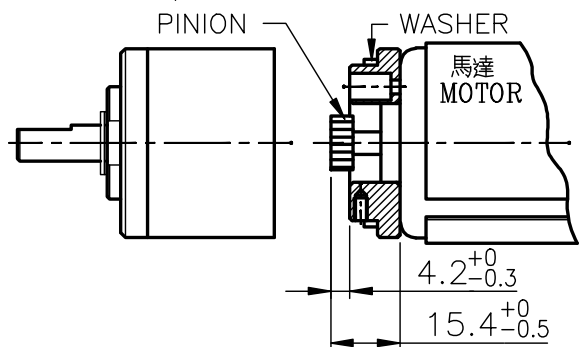

★ 使用相對溼度: 20%~85%RH    ★ 使用溫度範圍:  $-10^\circ\text{C} \sim +60^\circ\text{C}$   
Operating relative humidity    Operating temperature range

## 標準減速比型式 / GEARBOXES SPECIFICATIONS

減速比 Reduction ratio	精確減速比 Exact reduction ratio	定格容許扭力 Rated tolerance torque	瞬間容許扭力 Max momentary tolerance torque	效率 Efficiency	L	重量(含油軸承) Weight (g) Sleeve bearings	重量(滾珠軸承) Weight (g) Ball bearings
1/4	4	3.0 kgf-cm Max.	9.0 kgf-cm	80%	32.5	141	139
1/14, 1/17, 1/24	14, 17 1/3, 24	8.0 kgf-cm Max.	24.0 kgf-cm	70%	39.2	193	191
1/49, 1/61, 1/84	49, 60 2/3, 84	18.0 kgf-cm Max.	54.0 kgf-cm	60%	45.9	233	231
1/104, 1/144	104, 144	20.0 kgf-cm Max.	60.0 kgf-cm	60%	45.9	233	231
1/212, 1/294	212 1/3, 294	25.0 kgf-cm Max.	75.0 kgf-cm	50%	52.6	283	281
1/504, 1/624	504, 624	30.0 kgf-cm Max.	90.0 kgf-cm	50%	52.6	283	281
1/720, 1/864	720, 864	30.0 kgf-cm Max.	90.0 kgf-cm	50%	52.6	283	281
1/1062	1061 2/3	30.0 kgf-cm Max.	90.0 kgf-cm	40%	59.6	328	326
1/1470, 1/2500	1470, 2500	30.0 kgf-cm Max.	90.0 kgf-cm	40%	59.6	328	326
1/3000, 1/3600	3000, 3600	30.0 kgf-cm Max.	90.0 kgf-cm	40%	59.6	328	326

# IG-42GM

## 01&02 TYPE



REDUCTION RATIO	L	REDUCTION RATIO	L
1/4	32.5	1/212~1/864	52.6
1/14~1/24	39.2	1/1062~1/3600	59.6
1/49~1/144	45.9		

外形尺寸 APPEARANCE SIZE

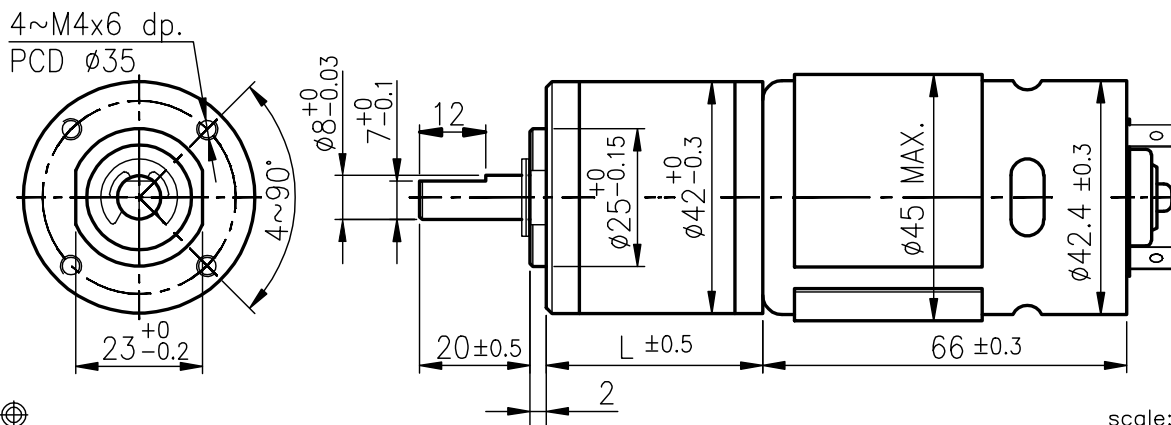

GEARED MOTOR TORQUE/SPEED

	減速比 Reduction ratio	1/4	1/14	1/17	1/24	1/49	1/61	1/84	1/104	1/144	1/212	1/294	1/504	1/624	1/720	1/864	1/1062	1/1470	1/2500	1/3000	1/3600
12V	定格扭力(Kg-cm) Rated torque	2.2	6.5	8.1	10	18	18	18	20	20	25	25	30	30	30	30	30	30	30	30	30
	定格回轉數(rpm) Rated speed	1400	405	325	248	120	98	76	63	45	31	24	13.5	10.9	9.5	8.0	6.5	4.6	2.7	2.3	1.9
24V	定格扭力(Kg-cm) Rated torque	1.8	5.4	6.6	9.5	16	18	18	20	20	25	25	30	30	30	30	30	30	30	30	30
	定格回轉數(rpm) Rated speed	1445	420	340	240	122	102	77.5	63	47	31	23.8	13.5	10.9	9.5	8.0	6.5	4.6	2.7	2.3	1.9

馬達單體型式 / MOTOR DATA

定格電壓 Rated volt (V)	定格扭力 Rated torque (g-cm)	定格回轉數 Rated speed (rpm)	定格電流 Rated current (mA)	無負荷回轉數 No load speed (rpm)	無負荷電流 No load current (mA)	定格出力 Rated output (W)	重量 Weight (g)
12	700	5700	≤ 5500	7000	≤ 900	41.3	360
24	570	5900	≤ 2100	7000	≤ 500	34.7	360

馬達單體特性圖 / MOTOR CHARACTERISTICS

