

## IG-30

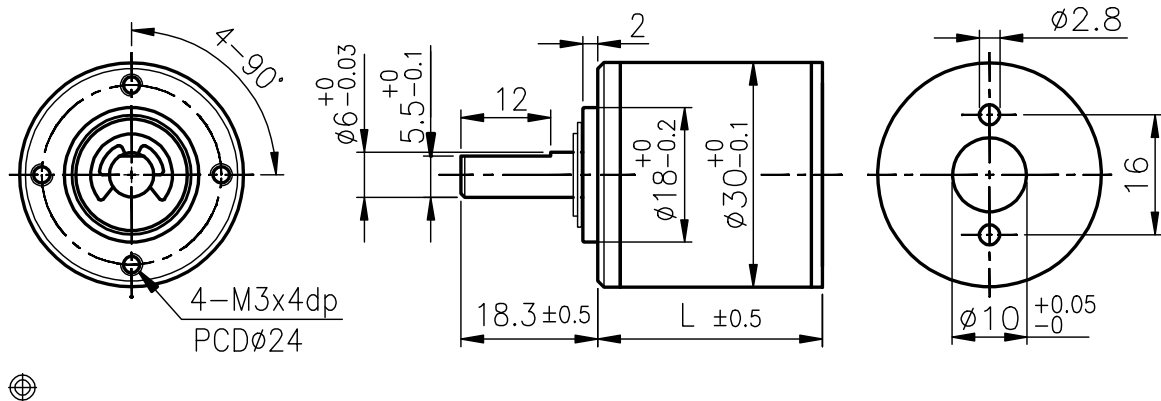

外殼材質 Housing material	金屬 metal	背隙 (無負荷時) Backlash, at no-load	$\leq 2.5^\circ$
輸出軸承型式 Bearing at output		含油軸承 Sleeve bearings	滾珠軸承 Ball bearings
徑向負荷 Radial load (10mm from flange)		$\leq 3 \text{ kgf}$	$\leq 3.5 \text{ kgf}$
軸向負荷 Shaft axial load		$\leq 2.5 \text{ kgf}$	$\leq 2.5 \text{ kgf}$
主軸最大承受壓入力 Shaft press fit force, max.		$\leq 10 \text{ kgf}$	$\leq 10 \text{ kgf}$
徑向間隙 Radial play of shaft		$\leq 0.08 \text{ mm}$	$\leq 0.05 \text{ mm}$
軸向間隙 Thrust play of shaft		$\leq 0.3 \text{ mm}$	$\leq 0.3 \text{ mm}$

外形尺寸 APPEARANCE SIZE



馬達齒輪型式 / PINION SPECIFICATIONS

模 數 Module	0.5			
齒 數 No. of teeth	11		17	8
壓 力 角 Pressure angle	20°			
孔 徑 Hole diameter	ø2.28, ø2.48, ø2.98			ø2.28
減 速 比 Reduction ratio	1/5, 1/71, 1/264,	1/19, 1/100, 1/516,	1/27 1/139 1/721	1/4 1/14 1/51 1/189
				1/35 1/939

馬達裝卸方法 / MOTOR INSTALLATION

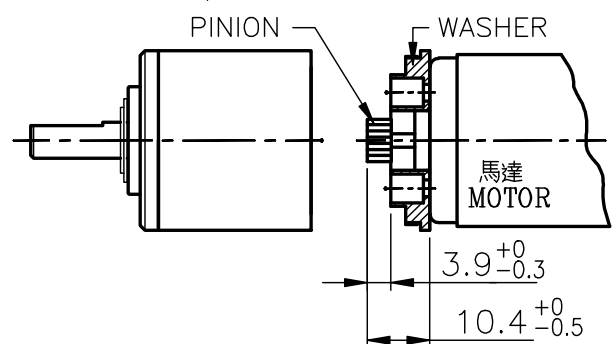

★ 使用相對溼度: 20%~85%RH    ★ 使用溫度範圍: -10°C~+60°C  
Operating relative humidity    Operating temperature range

標準減速比型式 / GEARBOXES SPECIFICATIONS

減速比 Reduction ratio	精確減速比 Exact reduction ratio	定格容許扭力 Rated tolerance torque	瞬間容許扭力 Max momentary tolerance torque	效率 Efficiency	L	重量(含油軸承) Weight (g) Sleeve bearings	重量(滾珠軸承) Weight (g) Ball bearings
1/4,1/5	3 12/17, 5 2/11	2.0 kgf-cm Max.	6.0 kgf-cm	80%	23.6	79	78
1/14,1/19	13 212/289, 19 38/187	3.0 kgf-cm Max.	9.0 kgf-cm	70%	30.0	92	91
1/27,1/35	26 103/121, 34 43/44	4.0 kgf-cm Max.	12.0 kgf-cm	70%	30.0	92	91
1/51,1/71	50 4397/4913, 71 524/3179	6.0 kgf-cm Max.	18.0 kgf-cm	60%	36.4	107	106
1/100	99 1044/2057	8.0 kgf-cm Max.	24.0 kgf-cm	60%	36.4	107	106
1/139	139 184/1331	8.0 kgf-cm Max.	24.0 kgf-cm	60%	36.4	107	106
1/189	188 51013/83521	10.0 kgf-cm Max.	30.0 kgf-cm	50%	42.8	122	121
1/264	263 39370/54043	10.0 kgf-cm Max.	30.0 kgf-cm	50%	42.8	122	121
1/516	515 14254/22627	10.0 kgf-cm Max.	30.0 kgf-cm	50%	42.8	122	121
1/721	720 14481/14641	10.0 kgf-cm Max.	30.0 kgf-cm	50%	42.8	122	121
1/939	939 975/5324	10.0 kgf-cm Max.	30.0 kgf-cm	50%	42.8	122	121

# IG-30GM

## 03&04 TYPE

REDUCTION RATIO	L	REDUCTION RATIO	L
1/4~1/5	23.6	1/51~1/169	36.4
1/14~1/35	30.0	1/189~1/939	42.8



外形尺寸 APPEARANCE SIZE

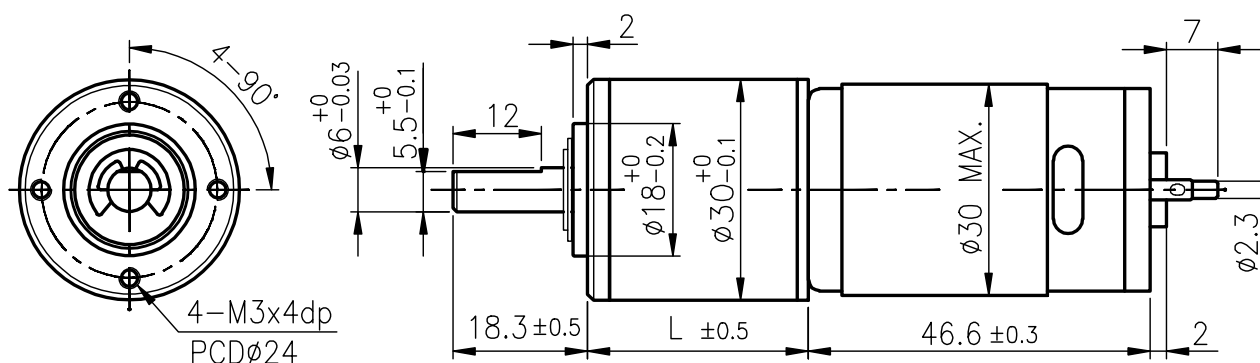

scale: 1:1

GEARED MOTOR TORQUE/SPEED

	減速比 Reduction ratio	1/5	1/14	1/19	1/27	1/35	1/51	1/71	1/100	1/139	1/189	1/264	1/516	1/721	1/939					
12V	定格扭力(Kg-cm) Rated torque	0.45	1.1	1.5	2.1	2.7	3.4	4.7	6.6	8	10	10	10	10	10					
	定格回轉數(rpm) Rated speed	1120	430	310	221	170	117	83	60	45	32	25	13.2	9.6	7.3					
24V	定格扭力(Kg-cm) Rated torque	0.54	1.2	1.7	2.4	3.1	4.0	5.5	7.8	8	10	10	10	10	10					
	定格回轉數(rpm) Rated speed	1150	445	320	229	176	121	87	62	46	34.5	26	13.5	9.8	7.3					

馬達單體型式 /MOTOR DATA

定格電壓 Rated volt (V)	定格扭力 Rated torque (g-cm)	定格回轉數 Rated speed (rpm)	定格電流 Rated current (mA)	無負荷回轉數 No load speed (rpm)	無負荷電流 No load current (mA)	定格出力 Rated output (W)	重量 Weight (g)
12	110	5950	≤ 900	7300	≤ 150	7.0	110
24	130	6160	≤ 500	7300	≤ 80	8.5	110

馬達單體特性圖 /MOTOR CHARACTERISTICS

