

IG-12

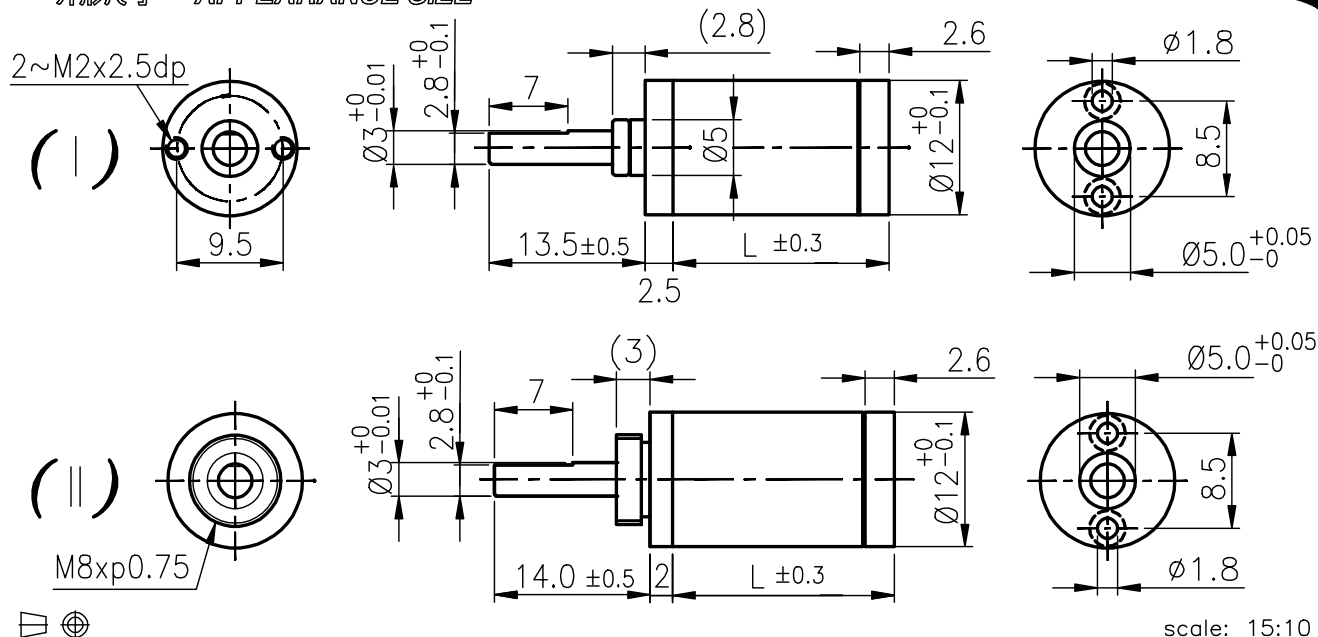

外殼材質 Housing material	金屬 metal	背隙 (無負荷時) Backlash at no-load	$\leq 3^\circ$
輸出軸承型式 Bearing at output	含油軸承 Sleeve bearings		
徑向負荷 Radial load (8mm from flange)	≤ 0.5 kgf		
軸向負荷 Shaft axial load	≤ 0.5 kgf		
主軸最大承受壓入力 Shaft press fit force, max.	≤ 1.5 kgf		
徑向間隙 Radial play of shaft	≤ 0.05 mm		
軸向間隙 Thrust play of shaft	≤ 0.2 mm		

外形尺寸 APPEARANCE SIZE



馬達齒輪型式 / PINION SPECIFICATIONS

模數 Module	0.25
齒數 No. of teeth	12
壓力角 Pressure angle	20°
孔徑 Hole diameter	Ø1.49
減速比 Reduction ratio	全種通用 Practicable

馬達裝卸方法 / MOTOR INSTALLATION

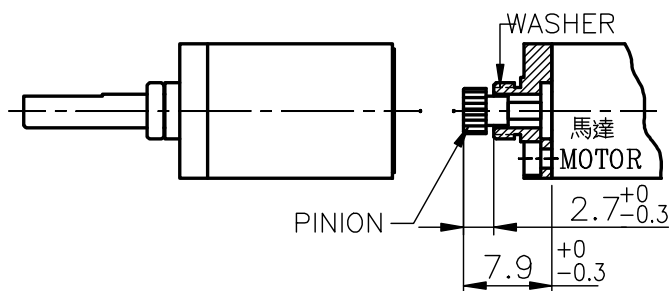

標準減速比型式 / GEARBOXES SPECIFICATIONS

★ 使用相對溼度: 20%~85%RH ★ 使用溫度範圍: -10°C~+60°C
Operating relative humidity Operating temperature range

減速比 Reduction ratio	精確減速比 Exact reduction ratio	定格容許扭力 Rated tolerance torque	瞬間容許扭力 Max momentary tolerance torque	效率 Efficiency	L	重量 Weight (g) (I)	重量 Weight (g) (II)
1/4	4	0.8 kgf-cm Max.	2.4 kgf-cm	85%	12.8	12.1	12.6
1/16	16	1.2 kgf-cm Max.	3.6 kgf-cm	75%	16.1	14.2	14.7
1/64	64	1.6 kgf-cm Max.	4.8 kgf-cm	65%	19.4	16.3	16.8
1/256	256	1.8 kgf-cm Max.	5.4 kgf-cm	55%	22.7	18.4	18.9
1/1024	1024	2.0 kgf-cm Max.	6.0 kgf-cm	45%	26.0	20.5	21.0
1/4096	4096	2.0 kgf-cm Max.	6.0 kgf-cm	40%	29.3	22.6	23.1

IG-12GM

01&02 TYPE

REDUCTION RATIO	L	REDUCTION RATIO	L
1/4	12.8	1/256	22.7
1/16	16.1	1/1024	26.0
1/64	19.4	1/4096	29.3



外形尺寸 APPEARANCE SIZE

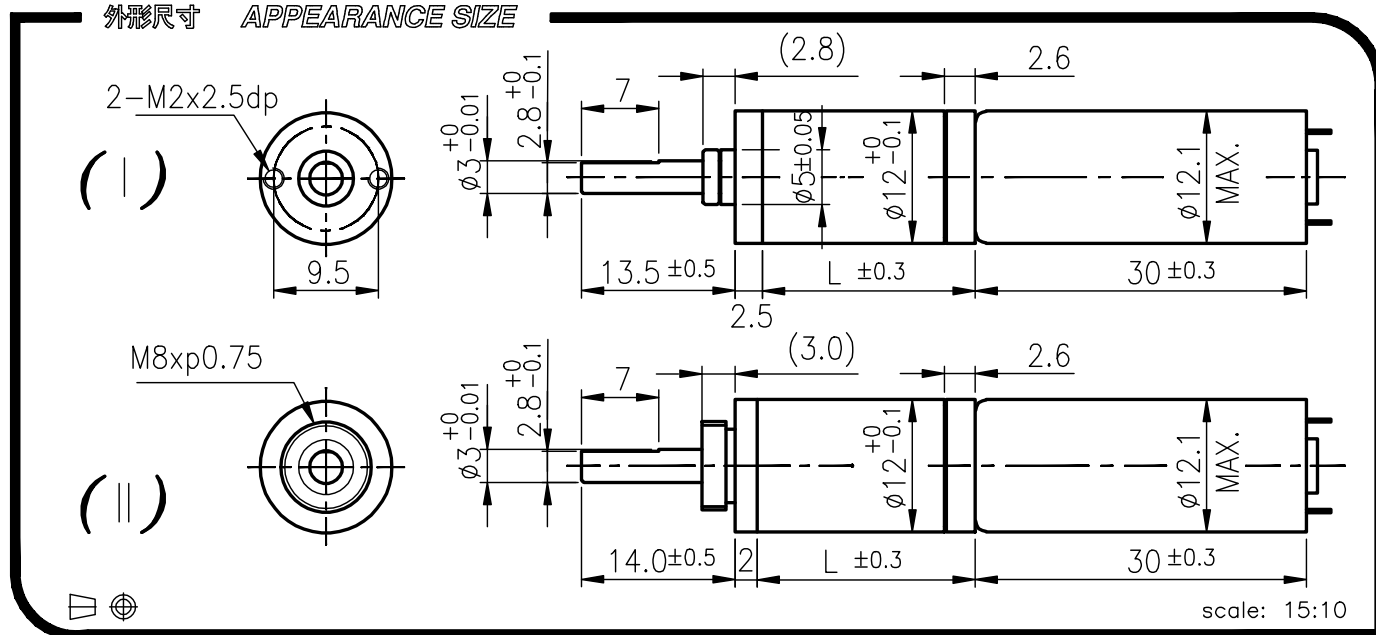

GEARED MOTOR TORQUE/SPEED

減速比 Reduction ratio	1/4	1/16	1/64	1/256	1/1024	1/4096	
2.4V 定格扭力(g-cm) Rated torque	20	70	250	840	2000	2000	
2.4V 定格回轉數(rpm) Rated speed	2400	600	150	38	10	2.8	

減速比 Reduction ratio	1/4	1/16	1/64	1/256	1/1024	1/4096	
3.0V 定格扭力(g-cm) Rated torque	19	65	230	780	2000	2000	
3.0V 定格回轉數(rpm) Rated speed	2400	610	150	39	10	2.8	

馬達單體型式 / MOTOR DATA

定格電壓 Rated volt (V)	定格扭力 Rated torque (g-cm)	定格回轉數 Rated speed (rpm)	定格電流 Rated current (mA)	無負荷回轉數 No load speed (rpm)	無負荷電流 No load current (mA)	定格出力 Rated output (W)	重量 Weight (g)
2.4	6.0	10000	≤ 450	12500	≤ 130	0.62	13
3.0	5.6	10000	≤ 340	12500	≤ 80	0.59	13

馬達單體特性圖 / MOTOR CHARACTERISTICS

